

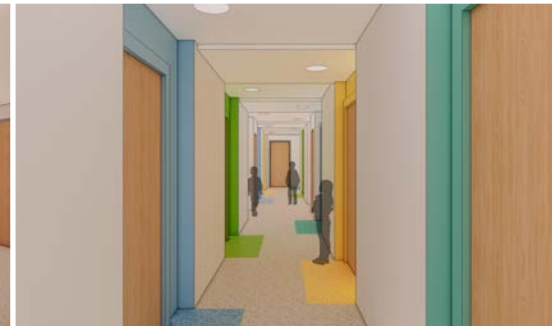

# CRESTWOOD CAMPUS

## Transformation & Modernization Project

*With your support, Hillside can do so much more for vulnerable children and families.*







# About Hillside's Crestwood Campus

The Crestwood Campus serves a unique role within Hillside's service portfolio, and a particularly critical role in the array of supports for New York State's young children in need.

Located in Rochester suburb of Chili in New York's Monroe County, the Crestwood Campus serves children ages 5-14 years from throughout a surrounding region of communities in Western New York and the Finger Lakes. These vulnerable children experience high levels of anxiety and depression, intellectual and developmental delays and other obstacles.

At Crestwood, these children receive the highest levels of care, including residential treatment and therapeutic education services that address diverse mental health and developmental needs that create potential barriers to their ability to thrive. Successful early outcomes represent their surest path to healthy, productive roles in their families and communities.

In addition to four residential treatment cottages, the campus is home to two schools for students in Grades K-4 and 4-8. Crestwood's schools serve approximately 30 children who receive 24/7 on-site residential treatment on the campus, plus approximately 120 more children who rely on Hillside for specialized day treatment classes.

To receive these day treatment services, some of these students must travel by school bus for up to three hours' round trip, each day—a clear indicator of both the urgent statewide need for this programming, and the importance of ensuring that the school provides the best educational experience possible.

## SERVING CHILDREN AGES 5-14 YEARS

**90%**

are diagnosed with one or more  
mental health challenges

**15%**

have co-occurring  
intellectual/developmental disabilities

**77%**

live within a 60-mile radius  
of the campus

## SERVICES PROVIDED

### 24/7 Residential Treatment

FOR UP TO  
**34 Children**

### Day Treatment

FOR UP TO  
**116 Children**

# The Plan

The environment in which services are delivered plays a vital role in the effectiveness of those services. The current state of the Crestwood Campus reflects its origins as a site designed and built in the 1960s: Although Hillside has maintained the property over the years, significant modernization is needed for the outdated facility to support the leading-edge service delivery that is critical to ensure successful outcomes among the children and families we serve.

*These strategic improvements will be achieved through a multi-phase project:*



## PHASE ONE

Internal/external **residential cottage refresh**



Creating a **warm, welcoming environment** that reduces youth stress and improves therapeutic connections

**Build a new cottage** between the Olympia and Valhalla cottages, with residential units and space for activities and family engagement



Facilitating **stronger family engagement** that supports ongoing treatment outcomes and eventual discharges to home- and community-based care

Create a **campus courtyard**



Enabling **greater access for therapeutic education** and recreation activities

**Remove asphalt and concrete** in key areas, supporting foot traffic only along with emergency vehicle use



Creating a **safer and more harmonious environment** for youth in care

Enhancements to **technology infrastructure**



Ensuring access to updated technology resources that support **more efficient and effective care** delivery



## PHASE TWO

Planning is underway for this phase, with components under consideration including an **additional residential unit, a multi-use space, natural perimeter fencing** around the property, and a **recreational nature trail**.



# Project Impact

Children should spend as little time as possible in residential treatment; youth belong with family settings, supported as needed by integrated community-based programs that pick up where residential treatment leaves off.

The Crestwood improvements will provide a more appropriate milieu for children in care, with the space and flow for stronger family interaction and integrated transition planning in a modernized, comfortable and trauma-informed environment.

Once completed, this project will allow for more opportunities for integrated work between residential education and community-based teams in partnership with the clinical team and families. This will provide an opportunity for families to work and acquire skills from on-campus treatment teams and plan for warm transitions back to their homes.

The renovated Crestwood Campus will better meet the needs of vulnerable youth and their families, while contributing to a stronger statewide mental health care system by ensuring an environment where children receive treatment that allows them to successfully return to family and community through lower lengths of stay and improved care.



Scan this QR code to see a brief video describing the current state and future plans for Hillside's Crestwood Campus.



# Timeline & Cost Projections

Architectural drawings and renderings were completed in spring 2025.

## PHASE ONE

Through late 2026

Build Cottage between Valhalla & Olympia Cottages.....	\$ 2,550,000
Remodel & Addition to Olympia Cottage...	\$ 2,070,000
Update Campus Core Courtyard.....	\$ 900,000
Infrastructure and Design Work .....	\$ 1,500,000
<b>Anticipated Total Phase One Costs .....</b>	<b>\$ 7,020,000</b>

## PHASE TWO

Summer 2026 through 2028

To be determined based on final determination of project scope.

For more information about Hillside's Crestwood Campus Transformation & Modernization Project, please contact **Calista Amering**, Chief Advancement Officer, at **585.275.7521** or **camering@hillside.com**.



# Thank You

We deeply appreciate your consideration of this proposal and its importance to the community of youth, adults and families served by Hillside.